

CAUTION! IS YOUR VALVE OPEN OR CLOSED?
MODEL 179-LP6 LOW PROFILE POSITION INDICATOR
Know the status of your buried service valve with the 179-LP6
from Valcom

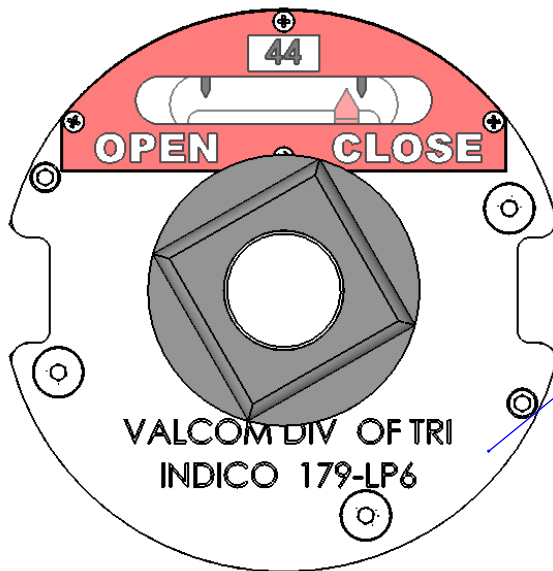

179-LP6

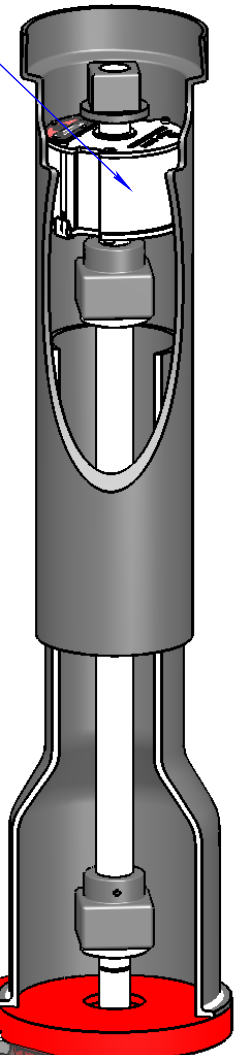

FEATURES:

Eliminates the need for VBAs or risers.
Wedgelock system holds unit securely in place.
Eliminates the need for precise height adjustment of stems.
Fits any valve box with a 6-1/8" ID or any 5-1/4" valve box with adjustable sleeve.
Can be used with locking covers, unit will slide past stop blocks.
Can be removed without digging up pavement.
Gear ratios to 900:1 standard one low price. Higher ratios avail.
Drop in installation, no accessories required. Ready to install.
Manufactured from corrosion resistant materials.
Sealed against dust and dirt, suitable for inground installation.
Fits into existing standpipes.
MADE IN THE USA

Valcom

Since 1986
INDICO®
BRAND

"INDICO" is a registered trademark
of the VALCOM div of TRI
508 668 5583

website www.tooling-research.com
email info@tooling-research.com

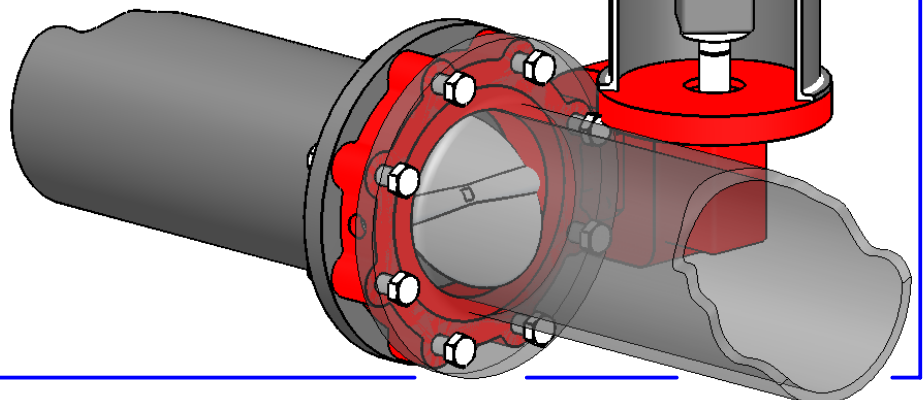

INDICO MODEL 179-LP6 POSITION INDICATOR MFG BY VALCOM DIV OF TRI WALPOLE, MA 02081

508 668 5583

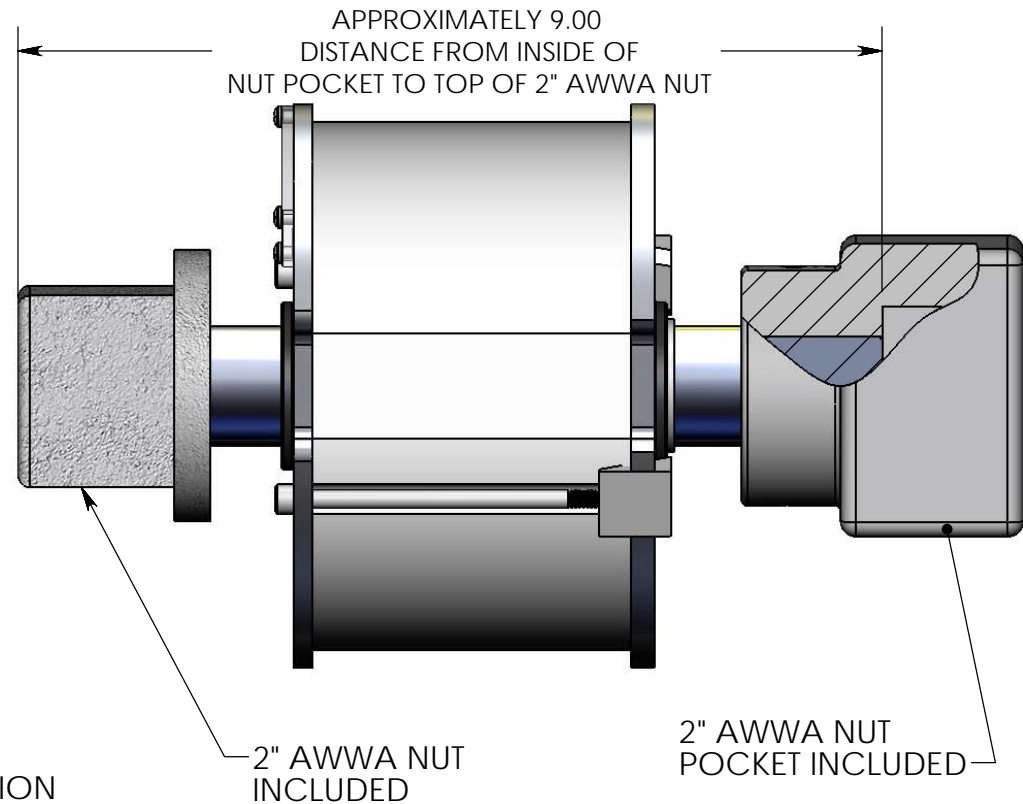
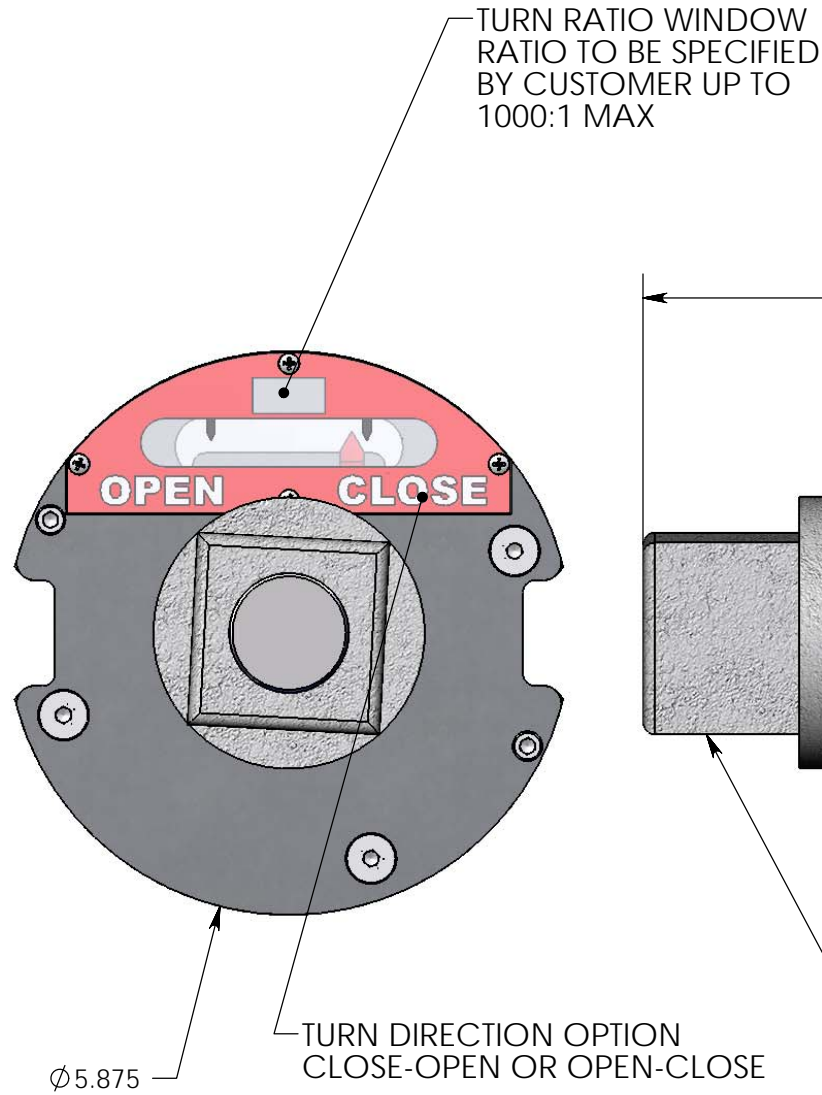

TOOLING RESEARCH INC.

81 DIAMOND ST. WALPOLE, MA 02081

508 668 1950

UNLESS OTHERWISE
SPECIFIED REMOVE ALL BURRS
AND SHARP EDGES

CUSTOMER CODE

THIRD ANGLE PROJECTION

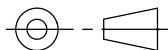

MATERIAL

FINISH

DO NOT SCALE DRAWING

DRAWN

MF

CHECKED

RESP ENG

MFG ENG

QTY PER ASSY

LOW PROFILE
POSITION INDICATOR

SIZE
A

DWG. NO.

179-LP6

REV.

SCALE

FILE REF:

SHEET 1 OF 1

THE INFORMATION CONTAINED IN
THIS DRAWING IS THE SOLE PROPERTY
OF TOOLING RESEARCH, INC. ANY
REPRODUCTION OF THIS DRAWING
IN WHOLE OR IN PART WITHOUT THE
WRITTEN PERMISSION OF TOOLING
RESEARCH, INC. IS PROHIBITED

UNLESS OTHERWISE SPECIFIED
DIMENSIONS ARE IN INCHES
TOLERANCES ARE:
FRACTIONS DECIMALS ANGLES
 $\pm 1/64$ $XX \pm .010$ $\pm 1^\circ$
 $XXX \pm .005$
 $XXXX \pm .0005$

INDICO MODEL 179-LP6 POSITION INDICATOR MFG BY VALCOM DIV OF TRI WALPOLE, MA 02081

508 668 5583

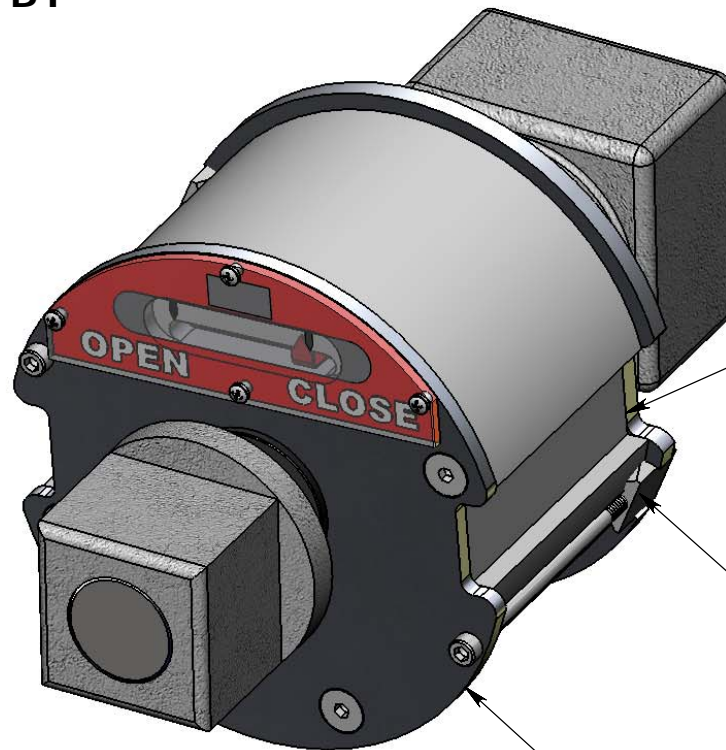

CLEARANCE FOR TABS
IN VB ALLOWS 179-LP6
TO ENTER PIPE AS REQ'D
TO ENGAGE STEM EXTENSION

WEDGE LOCK CLAMPS
PROVIDE SECURE POSITIONING
INSIDE VB

CLEARANCE ON TOP FLANGE
ALLOWS UNIT TO SLIDE INTO
ANY 6" DIA PIPE-CAN BE USED
WITH ANY STANDARD OR
LOCKING VB COVERS-ELIMINATE
THE NEED FOR VB RISER

TOOLING RESEARCH INC.

81 DIAMOND ST. WALPOLE, MA 02081

508 668 1950

UNLESS OTHERWISE
SPECIFIED REMOVE ALL BURRS
AND SHARP EDGES

CUSTOMER CODE

THIRD ANGLE PROJECTION

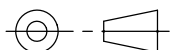

MATERIAL

FINISH

DO NOT SCALE DRAWING

DRAWN

MF

CHECKED

RESP ENG

MFG ENG

QTY PER ASSY

LOW PROFILE
POSITION INDICATOR

SIZE A	DWG. NO. 179-LP6	REV.
SCALE	FILE REF:	SHEET 1 OF 1

THE INFORMATION CONTAINED IN
THIS DRAWING IS THE SOLE PROPERTY
OF TOOLING RESEARCH, INC. ANY
REPRODUCTION OF THIS DRAWING
IN WHOLE OR IN PART WITHOUT THE
WRITTEN PERMISSION OF TOOLING
RESEARCH, INC. IS PROHIBITED

UNLESS OTHERWISE SPECIFIED
DIMENSIONS ARE IN INCHES
TOLERANCES ARE:
FRACTIONS DECIMALS ANGLES
 $\pm 1/64$ $XX \pm .010$ $\pm 1^\circ$
 $XXX \pm .005$
 $XXXX \pm .0005$

NUMBER OF TURNS= GEAR RATIO
SPECIFY FROM 7 TO 900 TO 1
SPECIFY OPEN CW OR CCW

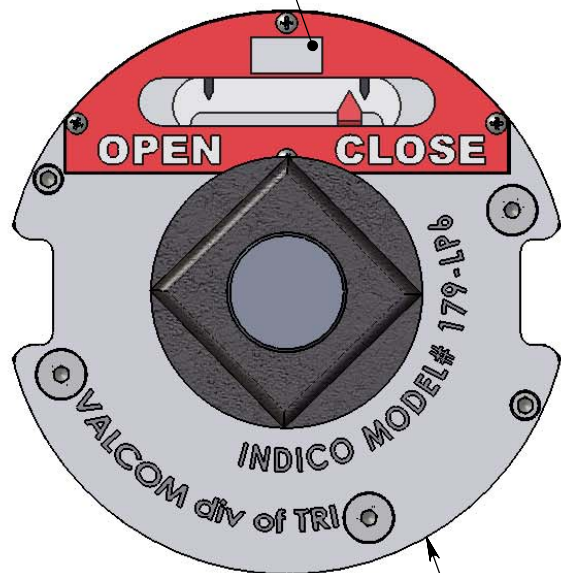

DIA A= STANDPIPE ID 6 OR 7 INCH
CIRCLE ONE

FILL IN REQUIRED INFORMATION
AND FAX BACK TO VALCOM div of TRI
508 668 5203
OR EMAIL TO info@tooling-research.com

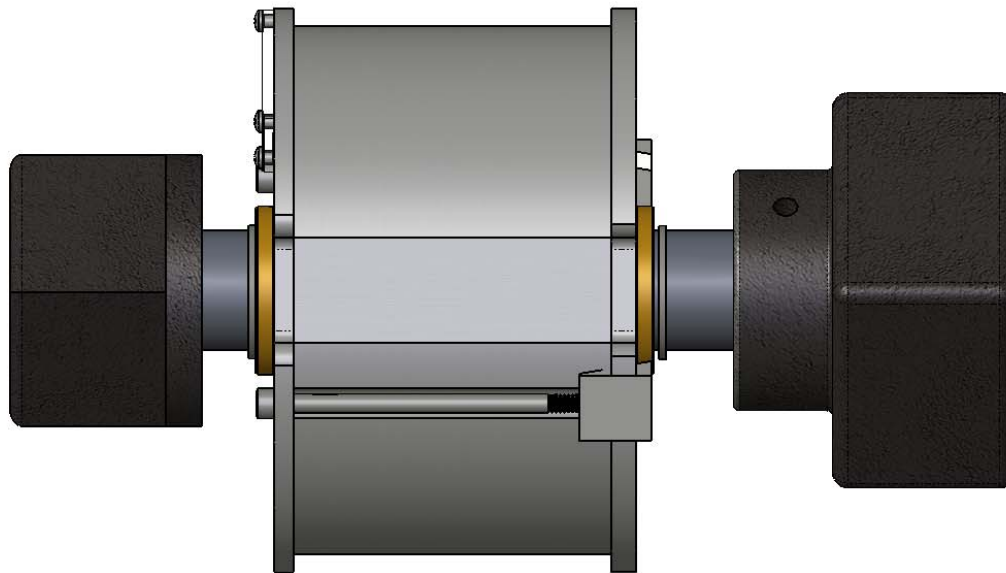

# OF TURNS	CW OR CCW	# OF UNITS
_____	_____	_____
_____	_____	_____
_____	_____	_____
_____	_____	_____
_____	_____	_____
_____	_____	_____

TOOLING RESEARCH INC.

81 DIAMOND ST. WALPOLE, MA 02081

508 668 1950

UNLESS OTHERWISE
SPECIFIED REMOVE ALL BURRS
AND SHARP EDGES

CUSTOMER CODE

THIRD ANGLE PROJECTION

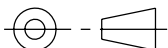

MATERIAL

FINISH

DO NOT SCALE DRAWING

DRAWN

MF

CHECKED

RESP ENG

MFG ENG

QTY PER ASSY

03-21-00

LOW PROFILE
POSITION INDICATOR
SERIES 179-LP

SIZE
A

DWG. NO.

179-LP

REV.

SCALE

FILE REF:

SHEET 1_ OF _1

THE INFORMATION CONTAINED IN
THIS DRAWING IS THE SOLE PROPERTY
OF TOOLING RESEARCH, INC. ANY
REPRODUCTION OF THIS DRAWING
IN WHOLE OR IN PART WITHOUT THE
WRITTEN PERMISSION OF TOOLING
RESEARCH, INC. IS PROHIBITED

UNLESS OTHERWISE SPECIFIED
DIMENSIONS ARE IN INCHES
TOLERANCES ARE:
FRACTIONS DECIMALS ANGLES
 $\pm 1/64$ $XX \pm .010$ $\pm 1^\circ$
 $XXX \pm .005$
 $XXXX \pm .0005$

Calibration Columns "The pump and valve accessory people"
Pulsation Dampeners
Electronic Valve Failsafes
Position Indicators
Modulating Tees
Stem Guides
Back Pressure Valves
Pressure Relief Valves

Valcom

A div of Tooling Research Inc.

81 Diamond St. PO Box 306 Walpole MA 02081
ph 508 668 5583 fax 508 668 5203

Website www.tooling-research.com

Installation of 179-LP low profile position indicator.

179-LP is designed to pass beyond locking hubs cast into standpipes and sit at any predetermined level within the pipe.

Note: Leave tape in place on Position indicator when installing for easier installation.

Insert position indicator into any 6" standpipe/ valve box until it engages 2" AWWA drive nut located on end of stem extension.

Insure that the arrow on the position indicator and the valve position coincide. IE if the valve is closed the position indicator arrow should be aligned with the black arrow on the closed side and vice versa.

Once located in position tighten two locking screws located at 180 degrees from each other on the top of the indicator using a long handled 5/32" Allen wrench. Preferably a ball driver type, but standard end will work. Tightening these screws will draw the two corresponding wedges between the indicator and the pipe wall providing a solid seat for the position indicator. Do not over tighten.

Install standard locking or non locking cover as required.

The 179-LP position indicator is designed to allow installation in any 6" standpipe without the necessity for a VBA. It can also be removed if required, and because of it's ability to fit entirely inside the pipe it eliminates the necessity for precise calculations of stem extension lengths.

Final note: It may be necessary in some instances to remove excess slag in some standpipes in order to allow the indicator to seat properly.